

John Fulton In Right of William

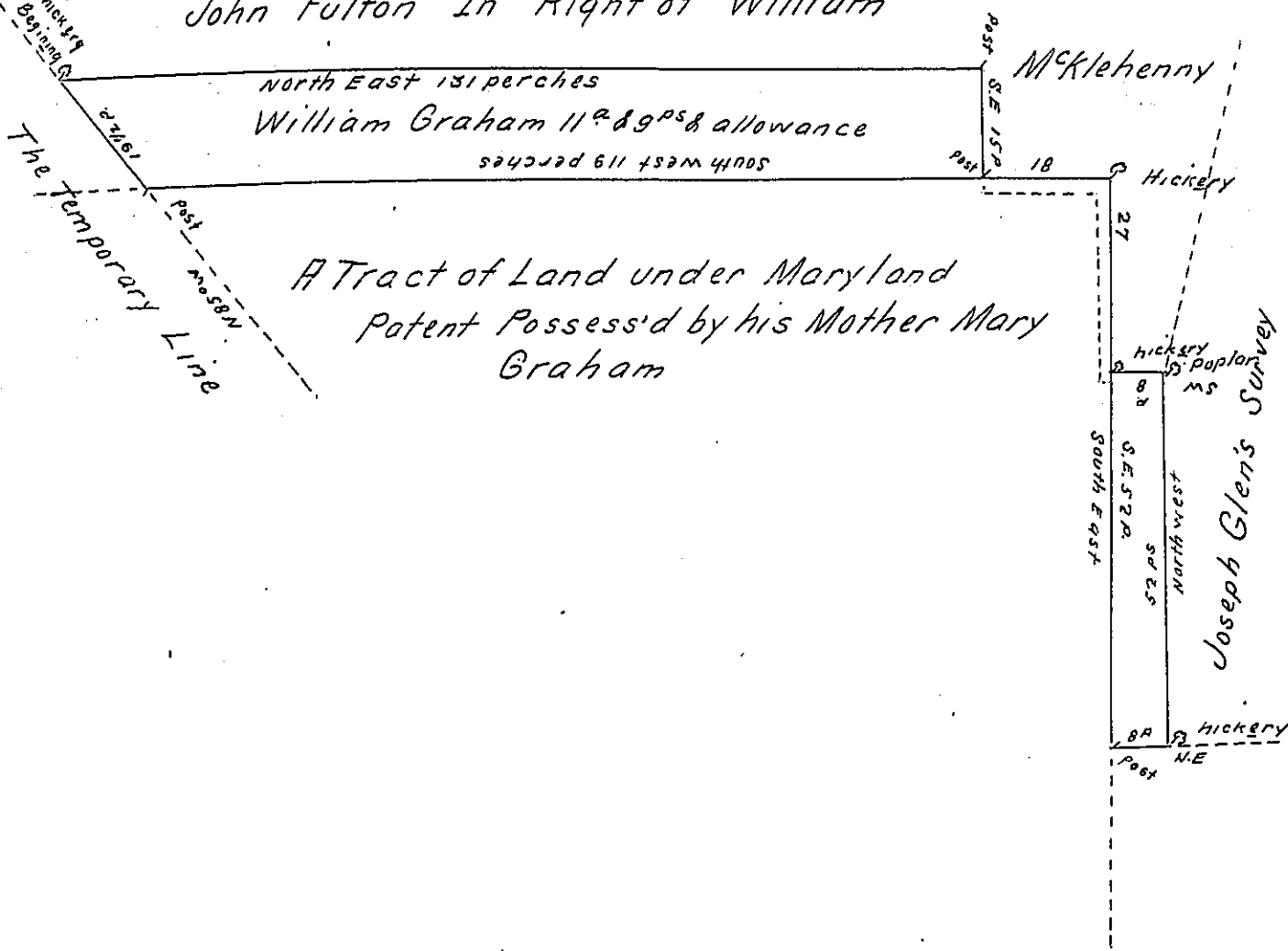

The Above Draught Describes 2 small Pieces of Land which were Survey'd the 19th of the 4th month (April) 1753. Unto William Graham (or Grymes) In Pursuance of a Warrant Granted unto him bearing Date the 21st Day of the Month called August 1752. Containing in both 13 1/2 acres & the Allowance at the Rate of 6^a per. Cent. That is, in the largest Piece 11 acres & nine perches, & in the other two acres one Quarter & thirty two perches; which both lay adjoining a Tract of Land in Possession of his Mother under Maryland Patent; & he desires to have both Pieces included in one Patent. if it (obl.) to take a Strip of 2 pe (obl.) es wide out of the Maryland P (obl.) nt to join (obl.) together in form of the Prick'd lines above Situate near Susquehanah River adjoining the Temporary Line in Little Britain Township Lancaster County Laid down by a Scale of 30 perches to an Inch & Certify'd.

By Geo. Churchman D.S.

IN TESTIMONY that the above is a copy of the original remaining on file in the Department of Internal Affairs of Pennsylvania, made conformably to an Act of Assembly approved the 16th day of February, 1833, I have hereunto set my Hand and caused the Seal of said Department to be affixed at Harrisburg, this twenty fourth day of October 1904

Joseph P. Perry
Secretary of Internal Affairs.